

Features

- Wide Wavelength Range
- Low Crosstalk
- High Stability, High Reliability
- Epoxy-free on Optical Path

Applications

- R&D in Laboratory
- System Monitoring
- OADM
- OXC



Specifications

Parameters	Unit	OSW-1x1	
Wavelength Range	nm	780~980,850&1310	1260 ~ 1650
Test Wavelength	nm	780 , 850 , 905 , 1310	1310 / 1550
Insertion Loss	dB	Typ: 0.5 Max: 0.8	
Return Loss	dB	MM ≥ 30	SM ≥ 55
Crosstalk	dB	MM ≥ 40	SM ≥ 55
PDL	dB	≤0.15	
ER	dB	≥18	
WDL	dB	≤0.35	
Repeatability	dB	≤±0.05	
Durability	Cycles	≥ 3X10 Million	
Switching Time	ms	≤5	
Optical Power	mW	≤500	
Operating Temperature	°C	-20 ~ +70	
Storage Temperature	°C	-40 ~ +85	
Relative Humidity	%	5 ~ 95	
Dimension	mm	(L)27×(W)12.0×(H)8.0(±0.2)	

Route States



Power Supply Requirement

Parameters	Voltage	current	Resistor
5V Latching	4.5~5.5	36~44mA	125Ω
5V Non-Latching	4.5~5.5	26~32mA	175Ω
3V Latching	2.7~3.3	54~66mA	50Ω
3V Non-Latching	2.7~3.3	39~47mA	70Ω

Pin Configurations

Type	Optical Route	Electric Drive				Status Sensor			
1x1		Pin 1	Pin 5	Pin 6	Pin 10	Pin 2-3	Pin 3-4	Pin 7-8	Pin 8-9
Latching	close	--	--	GND	V+	Close	Open	Open	Close
	P1-P2	V+	GND	--	--	Open	Close	Close	Open
Non-latching	close	--	--	--	--	Close	Open	Open	Close
	P1-P2	V+	--	--	GND	Open	Close	Close	Open

Dimension

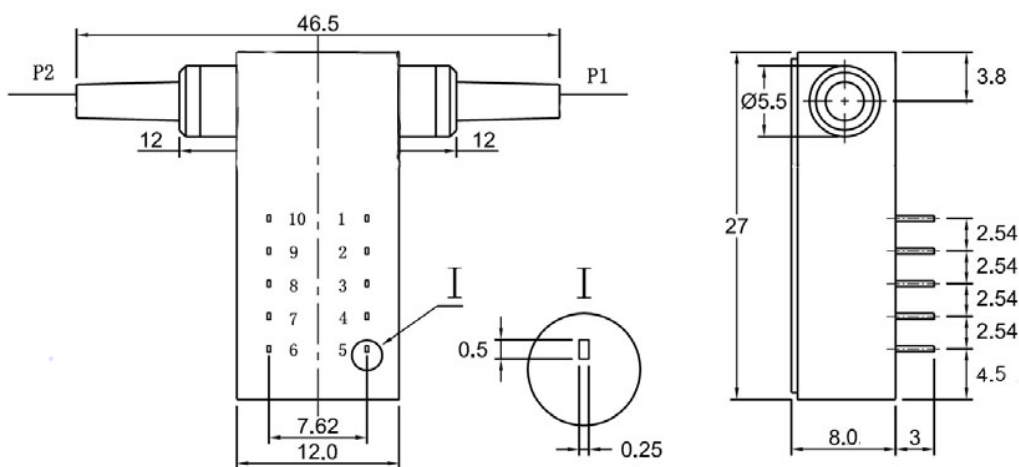

Ordering Information: OSW-1x1-A-B-C-D-E-F-G

A	B	C	D	E	F	G
Mode	Wavelength	Voltage	Control Model	Fiber Diameter	Fiber Length	Connector
SM:9/125um M5: 50/125um M6: 62.5/125um PM:PM	85: 850nm 90: 905nm 13: 1310nm 14: 1490nm 15: 1550nm 162: 1625nm 165: 1650nm 13/15:1310/1550nm	3: 3V 5: 5V	L: Latching N:Non-Latching	25:250um 90:900um	05:0.5m 10:1.0m 15:1.5m	OO:None FP: FC/PC FA: FC/APC SP: SC/PC SA: SC/APC LP: LC/PC LA: LC/APC